

# Welcome to LEAD Academy

Streamwood High School



**LEAD  
ACADEMY**

En español

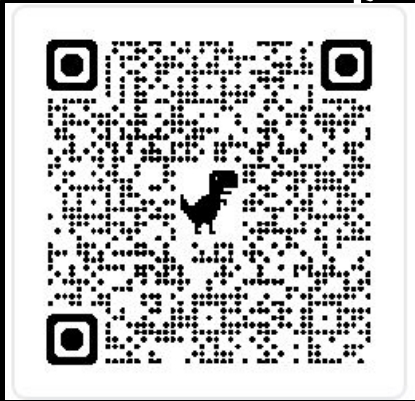



# Who's Who @ Streamwood High School – Administration

Dr. Jennifer VanDeusen  
Principal

Kim Rudden  
Associate Principal

Tracy Stewart  
Assistant Principal –  
Academy Director

---

Dr. Diane O'Connell  
Assistant Principal –  
STEM

Dr. Pedro Perez  
Assistant Principal –  
Humanities

Kyle Wright  
Assistant Principal –  
Freshman Success

---

Fernando Nieto  
Assistant Principal –  
Climate & Culture

Jason Ziols  
Athletic Director



# Who's Who @ Streamwood High School – Academy Staff

Meagen Balzer  
Freshman English  
INCubatoredu

---

Alexandra  
Panagakis  
ACcelerator

---

Melanee Stenstrom  
Freshman English



Clinton Hieber  
Academy Business

---

Ryan Sims  
LEAD Launch

---

Melanie Tomal  
Academy Integrated  
Math

# What to expect Next Year

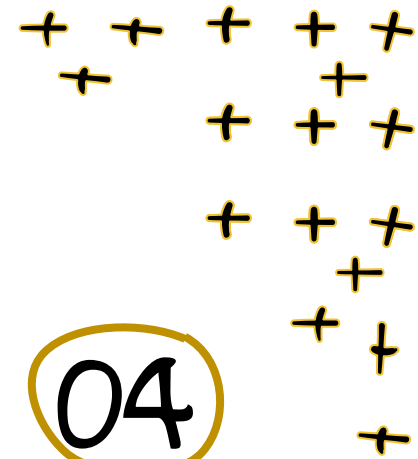

01

LEAD Launch

02

Academy Freshman  
English

03

Business for  
Innovators

04

Academy  
Integrated Math  
(Or appropriate placement)





# The Big Picture

	Freshman	Sophomore	Junior	Senior
<b>Fine Arts/CTE/WL</b> ( 6 credits)	Business for Innovators	Business for Entrepreneurs/ Mobile Makers	INCubator EDU	
<b>Math</b> ( 3 yr - 6 credits)	<b>AIM-1</b> (Academy Integrated Math) Or appropriate Math Placement	<b>AIM-2</b> (Academy Integrated Math) Or appropriate Math Placement	<b>AIM-3</b> (Academy Integrated Math) Or appropriate Math Placement	12th Grade Math/AP/DC
<b>English</b> ( 4 yr -8 credits)	Academy Freshman English	Academy Sophomore English	Academy Junior English	12 <sup>th</sup> Grade English/AP/DC
<b>Magnet</b>	LEAD Launch	LEAD Discover	World Issues/ Business Law	Accelerator OR Social Impact
<b>Social Studies</b> (US History, Civics/ Econ 4 credits)	+/- Elective	+/- Elective	U.S. History (APUSH)	Civics/Econ (AP Macro)
<b>Science</b> ( 2 yr - 4 credits)	Biology	Chemistry	Physics	+/- Science
<b>PE/Health</b> ( 4 yr -8 credits)	PE	PE/Health	PE	PE

This is an example. Students may be placed into courses based on their transcripts and appropriate placement. Courses included in this draft are subject to change.



# The Approach



## OUR DESIGN PROCESS



### DISCOVER

What do we want to change?  
What are the issues?  
Who do they impact?

STEP  
01

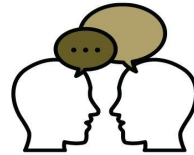

STEP  
02

### INTERPRETATION

How can we make a change?  
Engage in empathic  
brainstorming

### IDEATION

Make the Change  
Create the plan: resources,  
prototype, timeline and  
teamwork

STEP  
03

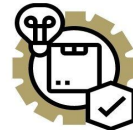

STEP  
04

### EXPERIMENTATION

Implement your plan  
Reflect on first attempt and  
revise

### EVOLUTION

Share and Empower  
Communicate your  
experience to inspire others

STEP  
05

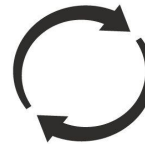



# The Space

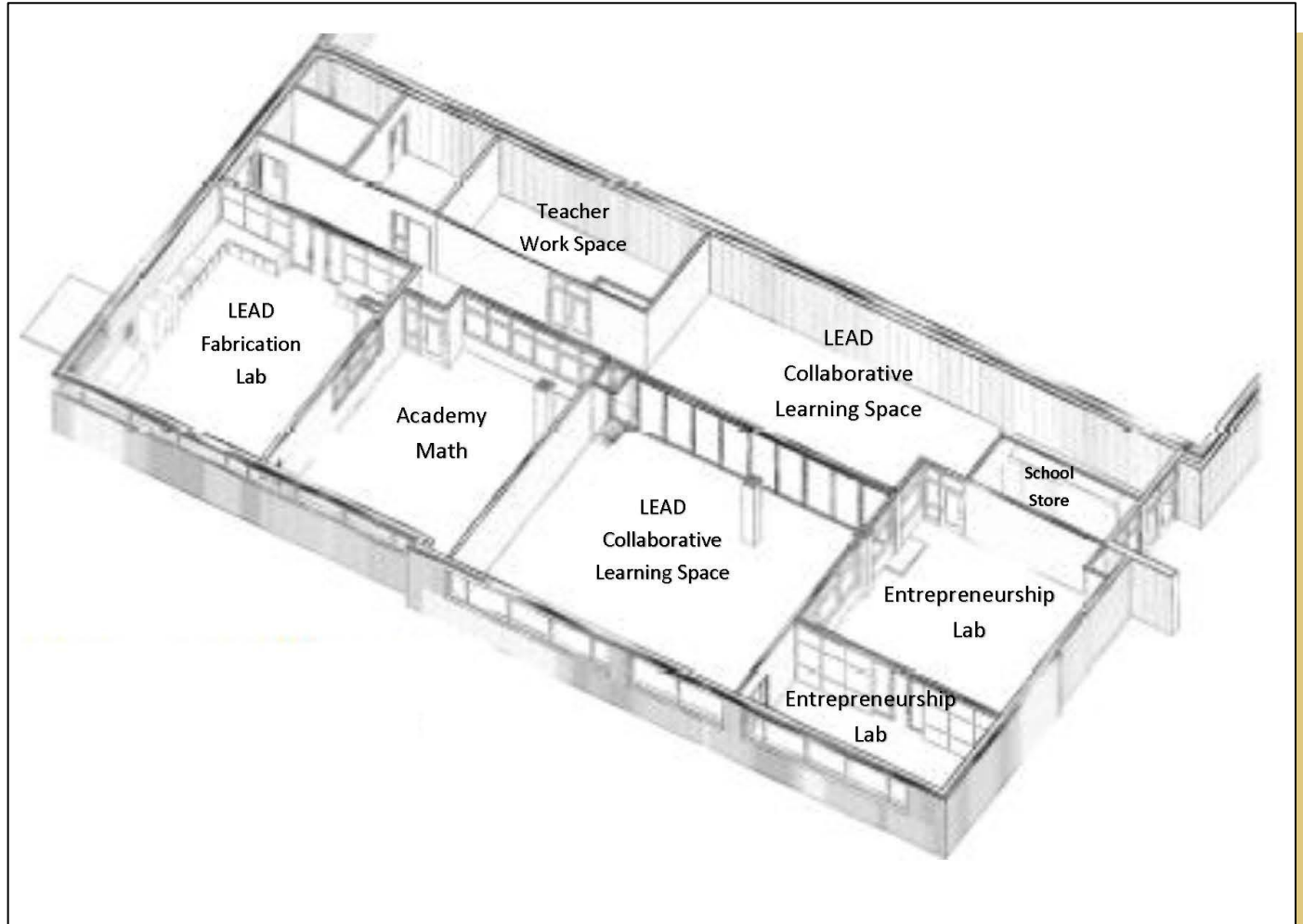

# Opportunities to Get Involved

- Academy Student Advisory Board
  - ◆ Provide feedback for program development
  - ◆ Plan academy events with LEAD staff
- Academy Parent Advisory Board
  - ◆ Provide feedback for program development

Student Advisory Board



Parent Advisory Board







You're  
Invited





**incubator**edu®@shs

*You're Invited!*

STREAMWOOD HIGH SCHOOL  
INCUBATOR PITCH NIGHT

Thursday May 19th, 2022  
6:00 PM - 8:00 PM  
Elgin Community College  
Building E - Seigle Auditorium



Questions?

